

# 2 x 2 Recessed Troffer "LYP" for Parabolic Louvers

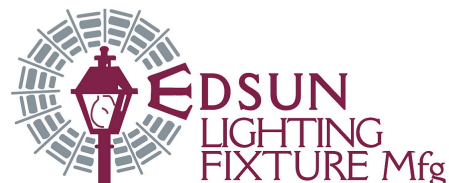

## GENERAL DESCRIPTION

A high performance recessed 2 x 2 troffer for 3" deep parabolic louvers. Designed for installation in exposed T-bar ceilings.

## SPECIFICATIONS

Housing: 5-3/4" deep. Die formed in either standard 23-gauge cold rolled steel to meet NYC specifications, with rolled side flanges for safety. Side flanges stand over parabolic convert a-lume. Provided with four corner tie points for safety-wire supports.

Ends: Snap in to housing and attach to parabolic body and side flanges with rivets. Built-in earthquake clips attach fixture to grid. Same ends fit 2 x 2 and 2 x 4 fixtures.

Socket Plates: Snap-in mounting style. Sockets are tilted forward to provide positive spring action contact with the lamps. Same socket plates fit 2 x 2 and 2 x 4 fixtures.

Ballast Cover: Snaps in without tools for easy installation.

Access Plate: Snaps in for simple ballast lead hook up without removing ballast cover.

Finish: All parts have a high reflective baked white enamel finish. Minimum 87% reflectivity.

## NOTES

Dimensions subject to change without notice.

Fixture available with optional heat removal vents. To order, add HR to end of catalog number. 6-10 week availability.

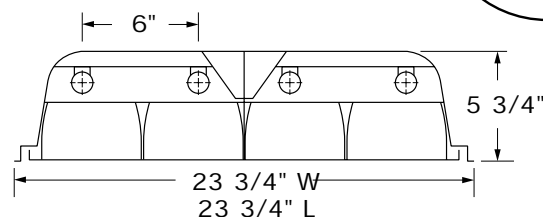
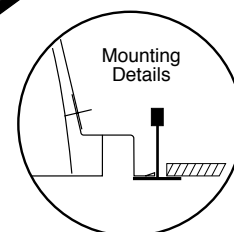
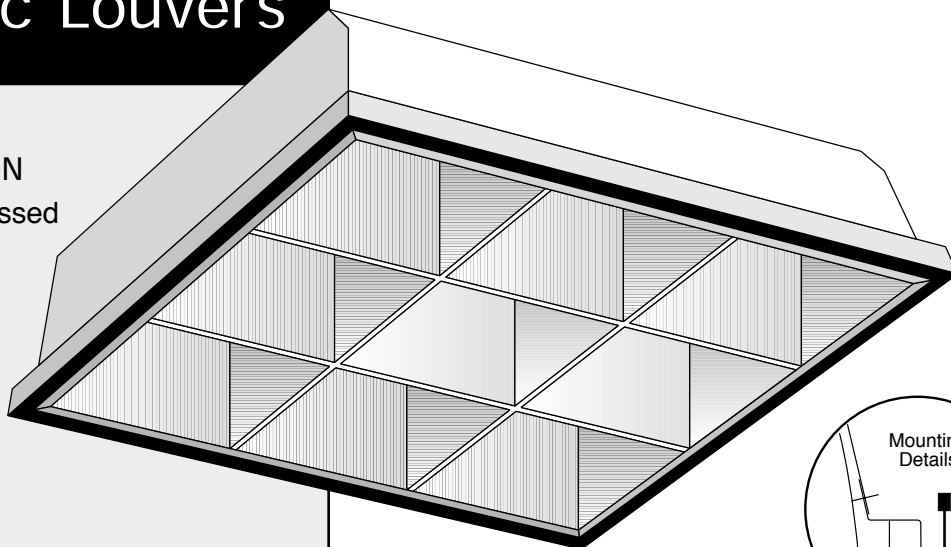

## ORDERING INFORMATION

Catalog No.	Lamps	Type
LYP22-2PLL40	2)PLL40	23 ga.
LYP22-U32	2)FB32U6	23 ga.
LYP22-3PLL40	3)PLL40	23 ga.
LYP22-2U31	2)U31	23 ga.
LYP22-3U31	3)U31	23 ga.
LYP22-U40	2)FB40U6	23 ga.
LYP22-320	3)F20	23 ga.
LYP22-420	4)F20	23 ga.
LYP22-317	3)F17	23 ga.
LYP22-417	4)F17	23 ga.

Available with T5



*Committed to Quality!*

569 W 17 St., Hialeah, FL 33010-2412

Ph.: 305-888-8849 • Fax: 305-883-0005

e-mail:sales@edsunlighting.com